

[Download Full Version 220-1002 Exam Dumps\(Updated in Feb/2023\)](#)

All button.

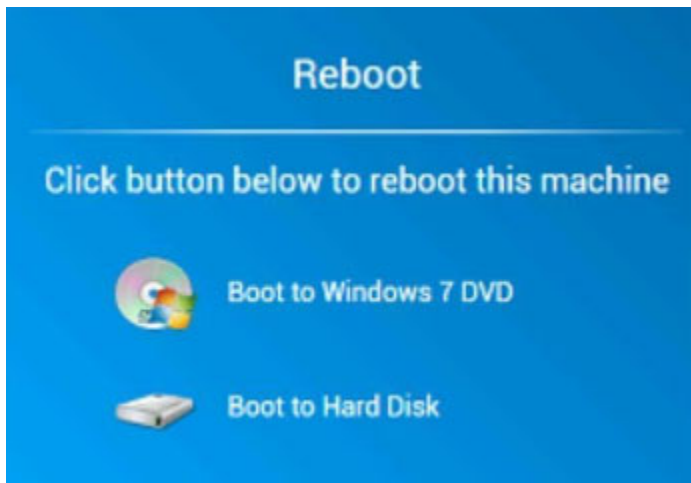

## [Download Full Version 220-1002 Exam Dumps\(Updated in Feb/2023\)](#)

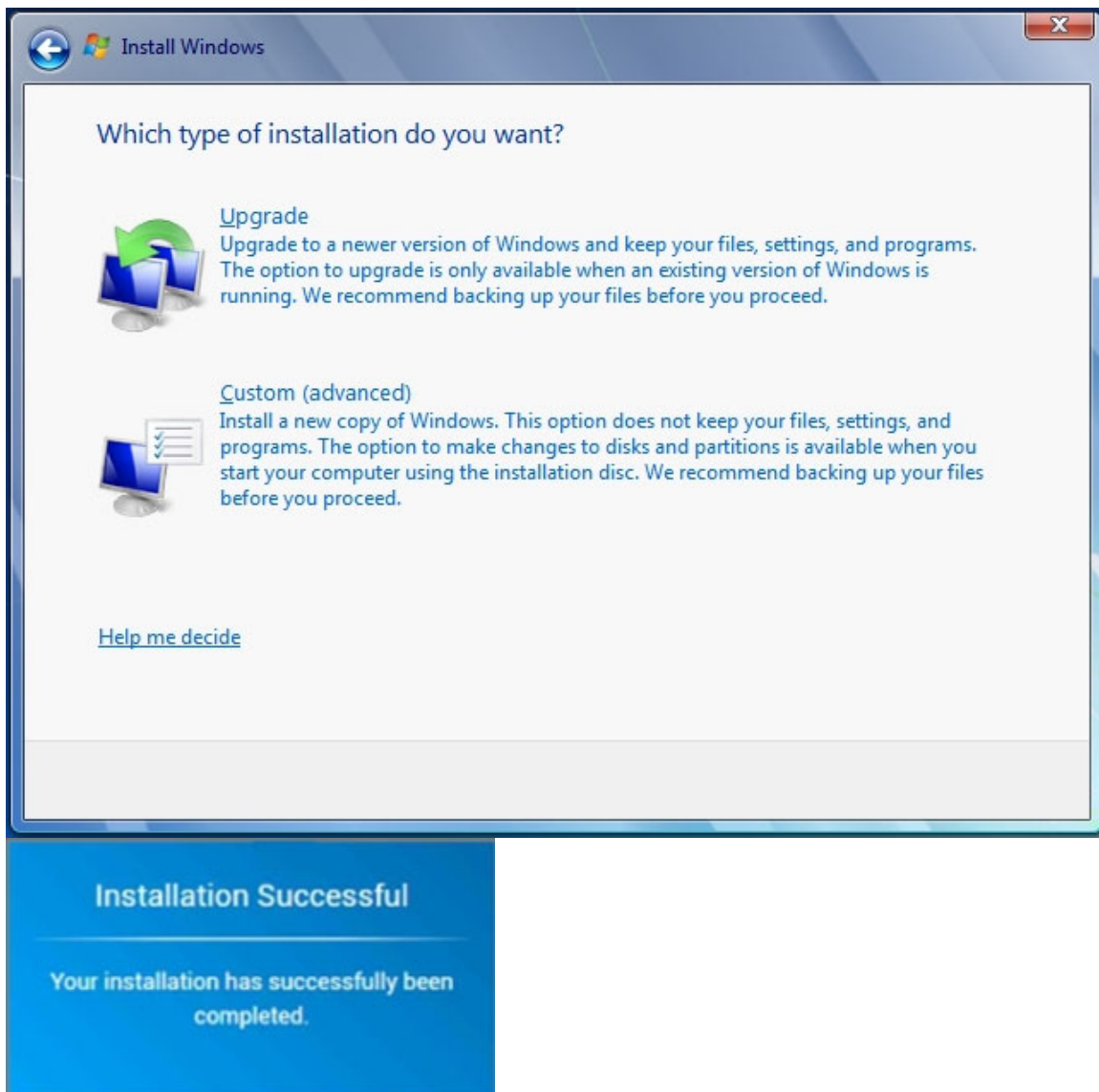

**Correct Answer:** Please see explanation.

**Explanation:**

Step 1: Choose Boot from Windows 7 DVD

Step 2: Click Repair

Step 3: Select Command Prompt

Step 4: Enter "bootrec /fixboot"

**QUESTION 288**

A company wants to move the contents of its users' My Documents folders from their local hard drives to a file server so they are backed up every night. Which of the following security concepts does this describe?

- A. Organizational units
- B. Folder redirection
- C. Group Policy
- D. Login script

## [Download Full Version 220-1002 Exam Dumps\(Updated in Feb/2023\)](#)

**Correct Answer:** A

### **QUESTION 289**

Which of the following are typically too dangerous to be disassembled by an in-house technician? (Choose two.)

- A. LCD monitor
- B. Power supply
- C. Laptop screen
- D. CRT monitor
- E. Motherboard
- F. Tablet

**Correct Answer:** AE

### **QUESTION 290**

An application is installed and configured locally on a workstation, but it writes all the save files to a different workstation on the network. Which of the following accurately describes the configuration of the application?

- A. Network-based
- B. Client/server
- C. Application streaming
- D. Peer-to-peer

**Correct Answer:** B

### **QUESTION 291**

Which of the following Microsoft operating systems comes with a PDF printer as part of the OS functionality?

- A. Windows 7
- B. Windows 8
- C. Windows 8.1
- D. Windows 10

**Correct Answer:** A

#### **Explanation:**

<https://helpx.adobe.com/acrobat/using/using-pdf-printer.html>

### **QUESTION 292**

A technician is installing a new SOHO wireless router and wants to ensure it is using the latest feature set and is secure. Which of the following should the technician perform FIRST?

- A. Change the default SSID
- B. Enable MAC filtering
- C. Update the firmware
- D. Set encryption

**Correct Answer:** C

## [Download Full Version 220-1002 Exam Dumps\(Updated in Feb/2023\)](#)

### **QUESTION 293**

A large corporation wants to secure its wireless network so only employees can connect. Which of the following technologies should be used to control access by user account?

- A. RADIUS
- B. WPA2
- C. TKIP
- D. AES

**Correct Answer: A**

### **QUESTION 294**

A user attempts to log in to a Windows PC, but the computer returns to the login screen after entering the correct username and password. A technician inspects the logs in Event Viewer and finds a message that corresponds to the user's login attempts:

The user profile for User15 could not be loaded. Ntuser.dat is missing or corrupt.

Which of the following would be MOST appropriate for resolving this issue?

- A. Boot into safe mode and log in as User15 Remove extraneous startup programs
- B. Go into System -> Advanced System Settings and remove the User15 profile.
- C. Run the command sfc /scannow.
- D. Delete the C:\Users\User15\ directory from the computer.

**Correct Answer: A**

### **QUESTION 295**

A desktop technician needs to replace a laptop's SSD. Which of the following must the technician use to prevent damage to the SSD during the replacement?

- A. Antistatic bags
- B. Needle-nose pliers
- C. Safety goggles
- D. ESD straps

**Correct Answer: D**

### **QUESTION 296**

A Windows user reports that clicking on links when browsing the Internet results in unexpected destination pages with advertisements or virus infection warnings. The user reboots the computer, but the issue persists. Which of the following should a technician perform to identify and resolve the issue? (Choose two.)

- A. Run a virus scan with updated signature files
- B. Uninstall any unknown browser extensions or add-ons
- C. Install the latest version of the Internet browser
- D. Enable SSL 3.0 in the browser settings
- E. Delete all unknown registry keys and reboot

**Correct Answer: AB**

## [Download Full Version 220-1002 Exam Dumps\(Updated in Feb/2023\)](#)

### **QUESTION 297**

Which of the following attack types exploits vulnerabilities in human nature?

- A. Zero-day
- B. Man-in-the-middle
- C. Spoofing
- D. Phishing

**Correct Answer:** D

### **QUESTION 298**

A Chief Executive Officer (CEO) is giving a presentation at an industry conference but forgot to bring a laptop. The company has emailed several large presentation files and the links to several videos that will be streamed during the presentation. While showing the last video, it starts to buffer, times out, and will not display. The CEO restarts the phone that is being used for the presentation and verifies there is enough free storage space, but the video still will not play. Which of the following is MOST likely causing the issue?

- A. Data transmission over limit
- B. Unauthorized account access
- C. Resource over use
- D. Unintended Bluetooth pairing

**Correct Answer:** A

### **QUESTION 299**

A home user reports slow computer performance and application crashes after clicking a "repair" button on a pop-up warning while browsing the Internet. Which of the following are the FIRST steps a technician should take to identify and resolve the issue? (Select TWO).

- A. Perform a system file check and replace any changed files with their original versions
- B. Enable the pop-up blocker on the Internet browser
- C. Uninstall any recently installed unknown programs and browser extensions,
- D. Perform a hard shutdown and cold boot the computer
- E. Scan the RAM and hard drive using an up-to-date antivirus program.

**Correct Answer:** BC

### **QUESTION 300**

A customer built a computer with the following specifications:

- Single hexa-core processor
- 8GB DDR4 memory
- 256GB SSD drive
- Built-in graphics card
- 32-bit Windows OS
- Audio editing software

The computer seems to be working, but the OS reports only 3.5GB of RAM is available. Which of the following would correct the issue?

[220-1002 Exam Dumps](#) [220-1002 PDF Dumps](#) [220-1002 VCE Dumps](#) [220-1002 Q&As](#)

<https://www.ensurepass.com/220-1002.html>